

Seville Lectern Sound System Owners Manual

MADE IN USA



A Message from the President

Congratulations on purchasing an Anchor Audio sound system, the choice of thousands of satisfied customers including the White House, prestigious universities, school districts nationwide, police and fire departments, and all branches of the U.S. military. Our products are made of the finest materials and built with pride in the U.S.

We've incorporated the latest technology into your sound system yet kept it simple to use. Just take a few minutes to review this manual to ensure the maximum enjoyment of your Anchor system. Or, you can view a demonstration video complete with a trouble shooting section at www.anchoraudio.com.

Feel free to call our friendly customer support staff at 1-800-ANCHOR1 Monday thru Friday between 7:00am and 5:00pm Pacific Standard Time with any questions. We love to hear from our customers.

Janet Jacobs, President
on behalf of all Anchor employees



CONTENTS

GETTING STARTED	1
BASIC SYSTEM OPERATION / CARING FOR THE SEVILLE	2
OPERATING THE BUILT-IN UHF WIRELESS RECEIVER	3
OPERATING THE WIRELESS MICROPHONE / TRANSMITTER	4
HAVING TROUBLE WITH YOUR SOUND SYSTEM? / TECHNICAL SPECIFICATIONS	5

GETTING STARTED

Please check your new unit carefully for any damage which may have occurred during shipment. Each Anchor product is carefully inspected at the factory and packed in specially designed boxes for safe transport.

Notify the freight carrier immediately of any damage to the shipping box or product. Repack the unit in the original box and wait for inspection by the carrier's claim agent. Notify your dealer of the pending freight claim.

NOTE: All damage claims must be made with freight carrier!

RETURNING SYSTEMS FOR SERVICE OR REPAIR

For service or repair, please contact the dealer you purchased your system from or Anchor Audio Customer Service at 800.262.4671 to obtain a RA (*Return Authorization*) number. You may also complete an online RA request form at www.anchoraudio.com. All shipments to Anchor Audio must include a RA number and must be shipped prepaid. C.O.D. shipments will be refused and returned at your expense.

IMPORTANT: Save the shipping box & packing materials, they were specially designed to ship your unit!

WARRANTY REGISTRATION

Visit our website at www.anchoraudio.com and select "Warranty Registration." Complete the online form to activate the six-year limited warranty on your Seville Lectern and two-year limited warranty for the microphones.

100-0203-000 01/11



SEVILLE LECTERN CONTROL PANEL - LP7500U2

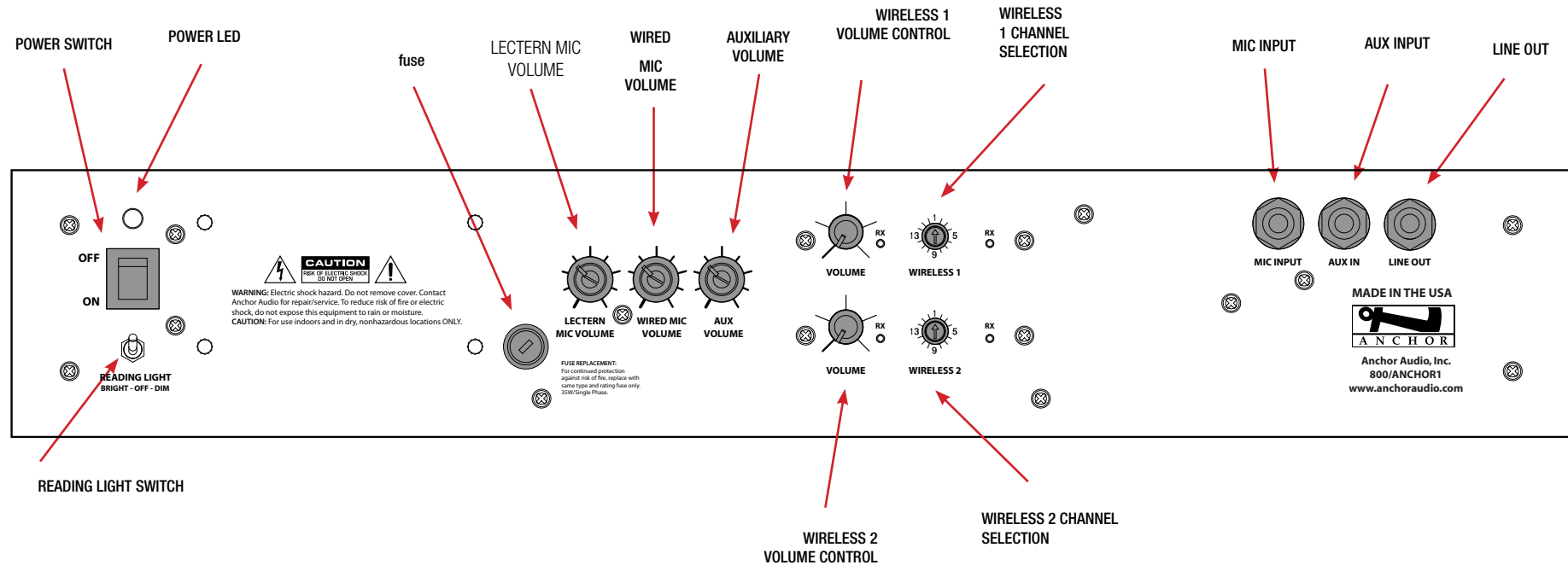

BASIC SYSTEM OPERATION

1. Position lectern in front of and facing the audience
2. Plug gooseneck/mic into the XLR jack located on the lectern top
3. Adjust microphone position
4. Set the Lectern Mic Volume to minimum
5. Plug the system power cord into a standard AC outlet
6. Turn system Power Switch ON - the Power LED should light
7. Speak into microphone and adjust the lectern mic control to desired volume level

NOTE: Elevate lectern when possible to project sound over listeners in front.

CARING FOR THE SEVILLE

Taking proper care of your new lectern will give you years of use. Clean the solid wood trim with an oil-based furniture polish, and the laminate surfaces with common household polish.



DIVERSITY WIRELESS BY ANCHOR AUDIO

Anchor Audio UHF wireless is a 16 channel, diversity wireless system that receives signals with two independent antennae. With diversity wireless the receiver processes the stronger signal, effectively minimizing dropouts and interference from other transmitting sources. The antennae are mounted internally so there are no obstructions or risk of damage.

CHANNEL SELECTION - BUILT-IN RECEIVER

Select a channel, set the built-in receiver & microphone transmitter to that channel before using your wireless system.

1. Choose any available wireless channel/frequency from 1 thru 16
(see page 4 for transmitter instructions)
2. Set the Wireless Channel Selector Knob to the channel/frequency you choose in step 1

If you have two wireless receivers repeat above for the second receiver. Remember, each receiver/transmitter pair must be set to different channels to avoid interference.

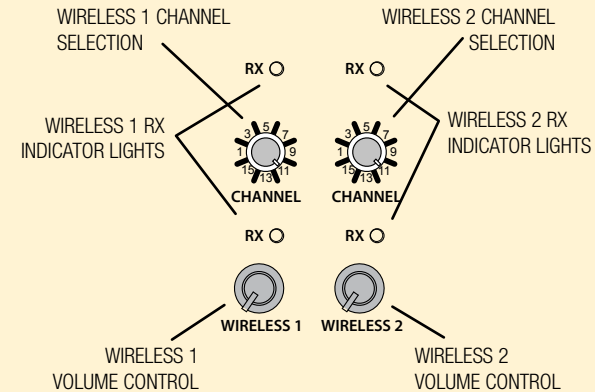

NOTE: Ongoing wireless interference? The frequency you selected may be in use by other systems in the area! Change channels until you find a clear frequency!

CONTROLLING FEEDBACK

Feedback, a howling noise or shrill sound, is self-generated by the sound system. It's caused by a microphone picking up the sound coming from the speaker and then reamplifying it. Once a feedback loop starts, it continues until the system is adjusted.

FEEDBACK CAUSES

- Microphone too close, pointing towards or in front of speaker
- Volume setting is too loud for room
- Sound reflecting off hard surfaces

CAUTION: Feedback can damage your equipment & may be hazardous to hearing.

AVOIDING & ELIMINATING FEEDBACK

- Point microphone in a different direction
- Keep microphone away from the speaker
- Place speaker in FRONT of the microphone
- Reduce the sound system volume levels

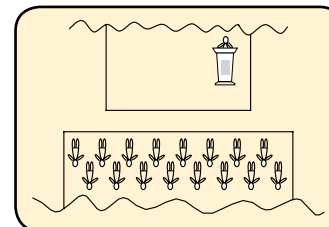

CORRECT SYSTEM PLACEMENT

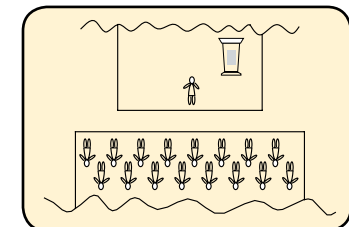

WRONG SYSTEM PLACEMENT



OPERATING THE WIRELESS MICROPHONE/TRANSMITTER

CHANNEL SELECTION - HANDHELD TRANSMITTER

1. Unscrew battery cover on bottom of microphone
2. Set the CHANNEL SELECTOR dial to match the channel setting of your receiver
3. Replace battery cover and tighten firmly

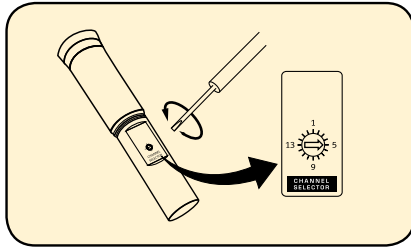

CHANNEL SELECTION - BODY-PACK TRANSMITTER

1. The channel selection dial is located on the side of the transmitter
2. Set the CHANNEL selection dial to match the channel setting of the receiver

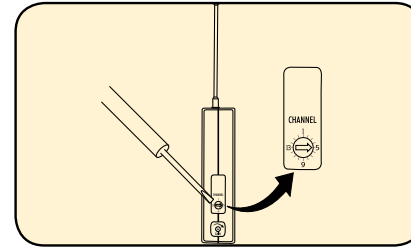

NOTE: When using dual wireless, each microphone must be set to a different channel!

USING YOUR WIRELESS MICROPHONES

After you have set the transmitter channel (see above) you are ready to use your wireless microphone:

1. Body-pack transmitter users must insert the mic plug into the transmitter jack marked MIC
2. Turn the transmitter power switch to ON
(The red LED will flash when the mic is turned on. If the red LED stays on, the battery is low)
3. Turn the Seville power switch to ON
4. The RX indicators will light *(only one indicator will light at a time)* when the wireless signal is being transmitted and received

CAUTION: Harmful feedback may occur when walking in front of a sound system or speaker with a wireless microphone. Always point microphone away from speakers!

REPLACE BATTERY - HANDHELD TRANSMITTER

1. Unscrew battery cover on bottom of microphone
2. Replace old batteries with two fresh size 'AA' alkaline batteries
3. Replace battery cover and tighten firmly

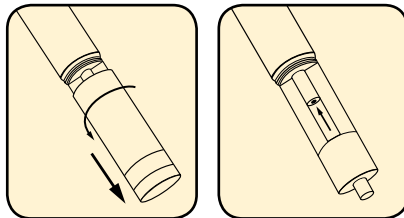

REPLACE BATTERY - BODY-PACK TRANSMITTER

1. Slide open battery cover on front of transmitter
2. Replace old batteries with two fresh size 'AA' alkaline batteries
3. Replace battery cover by sliding firmly into place

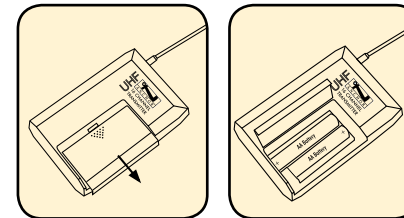

NOTE: Transmitter power must be OFF when changing batteries!



SIX YEAR WARRANTY

HAVING TROUBLE WITH YOUR WIRELESS SYSTEM? (WIRELESS MODELS ONLY)

CONDITION	POSSIBLE SOLUTION
No Sound (RX Indicator: ON)	<ul style="list-style-type: none"> • set POWER switch to RED position (<i>handheld mic only</i>) • turn up WIRELESS volume control
No Sound (RX Indicator: OFF)	<ul style="list-style-type: none"> • make sure mic is plugged into body pack transmitter • turn SEVILLE POWER switch on • make sure transmitter power switch is on • set receiver and transmitter to same channel • replace battery in transmitter

NEED MORE HELP? Acclaim Portable Lectern Setup & Operation Videos!
Visit Our Website: www.anchoraudio.com



Scan for Seville
Technical Specs



Scan for Seville
Brochure



Scan for Seville
Website



Scan for How to
Videos & Articles

SEVILLE TECHNICAL SPECIFICATIONS

Rated Power Output	22 Watts continuous	Inputs	
Max SPL @ Rated Power	107 dB @ 1 meter	Lectern Microphone	Lo-Z, balanced, phantom power, XLR
Frequency Response	65 Hz – 15 KHz	Auxiliary Microphone	Lo-Z, unbalanced, 1/4"-phone
AC Power Reqs.	110 – 125 V AC, 50/60 Hz	Aux	Hi-Z, unbalanced, 1/4"-phone
	210 – 240 V AC, 50/60 Hz	Sensitivity For Rated Output	
	(40 VA nominal, 120 VA max)	Microphone	-52 dBV (2.5 mVrms)
Speaker Type	6.5" woofer, high-output tweeter	Line	-14 dBV (200 mVrms)
Dimensions (HWD)	49" x 24" x 21"	Outputs	
	(125 x 61 x 53 cm)	Line (post fader)	buffer isolated, 1/4" phone
Weight	122 lbs/ 55 Kg		



(Specifications Subject to Change Without Notice)

ANCHOR AUDIO CUSTOMER SERVICE
800.262.4671

FOR ADDITIONAL INFORMATION
visit www.anchoraudio.com