

## TROUBLESHOOTING

### CAN'T HEAR A PERSON SPEAKING?

Increase headset volume using the headset volume button on the side of the belt pack. Push the + symbol button until you reach desired volume. In extremely loud environments, you will need to use the dual ear muff headset with noise cancelling properties. If you still can't hear, you may be out of range and need to move closer to the user network.

### MICROPHONE NOT PICKING UP YOUR VOICE?

First, adjust the microphone sensitivity setting on the side of the belt pack by pushing the + button incrementally until you reach desired sensitivity level. Move the microphone closer to your mouth and speak up clearly. For example, people with softer voices should set their belt packs to a more sensitive microphone level.

### BACKGROUND NOISE TRANSMITTING ACROSS SYSTEM?

Reduce the microphone sensitivity setting by pushing the - symbol button until you reach the desired level.

### TRANSMISSION IS WEAK?

Your rechargeable batteries may be running low. If batteries are weak, the Group LED's will slowly flash. Your belt pack needs to be recharged. If you need to keep working, you can use disposable alkaline batteries.

### PROPER INTERCOM ETIQUETTE

Anchorman is designed to allow 4 people to speak at once in close quarters and one person to speak at a time when the belt packs are far apart.. Use proper intercom etiquette - wait to break into the conversation network until the other belt pack users have stopped speaking. If a large number of users are in the network, we suggest PTT to allow members to jump in and out of conversation.



For videos on how to setup & use the AnchorMAN:  
[www.anchoraudio.com](http://www.anchoraudio.com)

## ANCHOR AUDIO CUSTOMER SERVICE

**888/444-6077 • 310/784-2300**

### TECHNICAL SPECIFICATIONS

Range (line of sight)		Headset Connector	4-pin male XLR
Duplex	250' / 75 m	Antenna	1/2 wavelength dipole
Simplex	2,500' / 750 m	Dimensions & Weight	
Selectable Groups	4	BP-900	4 x 4.65 x 1.75" / 101.6 x 118.1 x 44.5 mm
Frequency	945 - 951 MHz	H-2000S	13 oz / .37 kg (batteries installed)
Frequency Settings	4 per Group	H-2000	3.5 x 7.4 x 7.9" / 8.9 x 18.8 x 20 cm
Output Power	17 dBm (50mW)	H-2000	13 oz / .37 kg
Microphone	Dynamic	H-2000	3.5 x 7.4 x 7.9" / 8.9 x 18.8 x 20 cm
DC Requirements	9V - 1.2A	H-2000	16 oz / .45 kg
Batteries	4 "AA" NiMH rechargeable	Antenna	7.18" / 182.372 mm
Battery Charge Time	5.5 hours = Full Charge	Antenna Extension	3.5" / 89 mm
Battery Life - NiMH Rechargeable			
Receive Only	7.5 hours		
Continuous Transmit	3.5 hours		
Battery Life - Alkaline Disposable			
Receive Only	3.0 hours		
Continuous Transmit	1.0 hours		

*(Product descriptions & specifications subject to change without notice.)*



**Anchor Audio, Inc.**

Portable Sound Systems • Torrance, California

## AnchorMAN®

WIRELESS INTERCOM SYSTEM - PATENT PENDING



### OWNER'S MANUAL

#### CONTENTS

GETTING STARTED .....	2
BP-900 BELT PACK .....	3
BASIC OPERATION / SYSTEM RANGE / DIP SWITCH FEATURES .....	4
WHAT IS ANCHORMAN? .....	5
RECHARGEABLE BATTERIES .....	6
FREQUENTLY ASKED QUESTIONS .....	6
HEADSET OPERATION / MICROPHONE SENSITIVITY .....	7
USER ID SETTINGS .....	7
TROUBLESHOOTING .....	8
TECHNICAL SPECIFICATIONS .....	8

## A MESSAGE FROM THE OWNER

Thank you for choosing an Anchor Audio wireless intercom system. Our products incorporate state-of-the-art design and the finest quality of materials and workmanship. We're proud of our products and appreciate the confidence which you have shown by selecting an Anchor system.

I hope you'll take a few minutes to review this manual. We've incorporated several unique features into our products, and your knowledge of how to use them will enhance the performance and your enjoyment of the system.

Janet Jacobs, President  
on behalf of all Anchor Employees

## GETTING STARTED

Please check your new unit carefully for any damage which may have occurred during shipment. Each Anchor product is carefully inspected at the factory and packed in specially designed boxes for safe transport.

Notify the freight carrier immediately of any damage to the shipping box or product. Repack the unit in the original box and wait for inspection by the carrier's claim agent. Notify your dealer of the pending freight claim.

**NOTE: All damage claims must be made with freight carrier!**

### RETURNING SYSTEMS FOR SERVICE OR REPAIR

For service or repair, please contact the dealer where system was purchased or Anchor Audio Customer Service (800/262-4671 or 310/784-2300) to obtain a RA (Return Authorization) number. All shipments to Anchor Audio must include RA number and be shipped prepaid. C.O.D. shipments will be refused and returned at your expense.

Customers outside the USA must contact dealer where system was purchased for service or repair instructions.

**IMPORTANT: Save shipping box & packing materials, they're specially designed to ship your unit!**

### WARRANTY REGISTRATION & INFORMATION

Please go to our website, [www.anchoraudio.com](http://www.anchoraudio.com), and select "Warranty Registration". Completing this online registration form will activate your limited two-year warranty.

Warranty is void if the belt pack case or headset has been opened, screws have been removed or there is evidence of tampering.

Waste electrical and electronic products must not be disposed of with household waste. Please recycle where facilities exist. Check with your Local Authority or Retailer for recycling advice.



## HEADSET OPERATION

AnchorMAN wireless intercom systems use both single and dual-earpiece, noise cancelling headsets featuring 4-pin XLR connectors and dynamic microphones.

1. Put on headset and adjust for a firm, comfortable fit
2. Connect headset cable to belt pack jack using the XLR connector
3. Position boom microphone close to mouth
4. Headset Volume Control buttons are on belt pack adjust volume by pushing "+" or "-" repeatedly

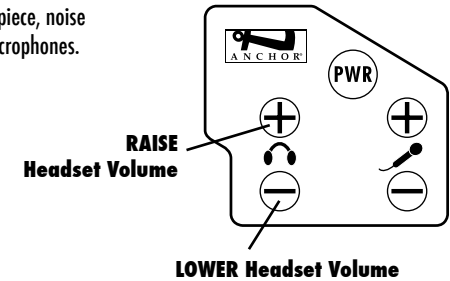

**For videos on how to setup & use your AnchorMAN:  
[www.anchoraudio.com](http://www.anchoraudio.com)**

## MICROPHONE SENSITIVITY

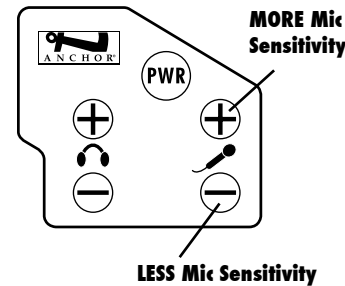

Use the Microphone +/- buttons to adjust voice detection sensitivity levels. Press + for more voice detection sensitivity and - for less. The highest + setting will pick up your voice even at a whisper.

The most sensitive settings should be used in very quiet environments with little or no back ground noise. Experiment with the Microphone Sensitivity level to ensure voice detection picks up the beginning and end of each sentence.

Remember, what you hear in your headset is what other members of the network will hear.

**CAUTION: Setting voice detection to an overly sensitive level can cause ambient background noise to trigger transmission, disturbing all members of the network.**

## USER ID SETTINGS

Each AnchorMAN belt pack is preset at the factory with an individual USER ID (1 - 4). If more than four users are required in a single group, use DIP switches 1 & 2 to assign belt packs to a USER ID. In groups of five or more, users will be required to share USER ID's. Each belt pack will be able to monitor all communications within the group, but only one user with a shared USER ID will be able to transmit at a time.

When you receive your AnchorMAN 4-user set each belt pack is labeled with 1, 2, 3 or 4, this number corresponds to the USER ID assigned to that unit at the factory. Additional labels have been included (numbers 1 - 4) to be used when changing USER ID's. Use the table at right when changing USER ID settings.

BP-900 Frequencies (MHz)				
	Group A	Group B	Group C	Group D
User 1	945	945.4	945.8	946.2
User 2	946.6	947	947.4	947.8
User 3	948.2	948.6	949	949.4
User 4	949.8	950.2	950.6	951

## RECHARGEABLE BATTERIES

AnchorMAN belt packs include 4 "AA" NiMH rechargeable batteries and AC Gang Charger. Fully charged NiMH batteries yield approximately 7 hours of normal use. Alkaline "AA" batteries can be used but battery life will decrease by half. Connecting the AC charger to a belt pack with alkaline batteries installed could seriously damage the system.

### INSTALL BATTERIES

1. Slide battery compartment door to remove
2. Install 4 "AA" NiMH rechargeable batteries

**NOTE:** Place "-" end of battery against spring.

3. Replace battery compartment door

**NOTE:** Flashing Group LED indicates battery low.

### CHARGE BATTERIES

1. Connect Gang Charger (included) into Charging Port on bottom of belt packs
2. Plug Gang Charger into AC outlet (Charging Port LED on = battery charging)
3. Charge belt pack for 5 hours (Charging Port LED off = battery fully charged)

**CAUTION:** Do not attempt to charge alkaline batteries.

Some users are required (for emergency preparedness, etc.) to leave their AnchorMAN units plugged into the charger at all times. For these applications we recommend replacing the rechargeable batteries every 12 months.

## FREQUENTLY ASKED QUESTIONS

### CAN I USE MY OWN HEADSET?

The AnchorMAN is designed to work with dynamic microphone elements. (Shields can be connected to chassis ground pin.) Headset pin configuration: 1 = Mic (-), 2 = Mic (+), 3 = Headphone (-), 4 = Headphone (+)

### I'VE RUN OUT OF BATTERY LIFE, NOW WHAT?

You can substitute "AA" alkaline batteries for the rechargeable batteries. However, connecting the battery charger to the belt pack when alkaline batteries are installed could seriously damage your belt pack.

### CAN MY ANCHORMAN WORK WITH OTHER WIRELESS INTERCOM SYSTEMS?

No. AnchorMAN uses a proprietary design and software exclusive to the product.

### CAN SOMEONE EAVESDROP ON MY CONVERSATION?

No. AnchorMAN is not penetrated by common scanners.

### IF I BREAK A HEADSET, WHAT DO I DO?

The H-2000 and H-2000S headsets are covered by a two-year warranty. Follow the instructions in the Getting Started section on page 2 for a Return Authorization. AnchorMAN headsets are sold separately if a replacement is needed.

### CAN I ADD BELT PACKS TO MY NETWORK?

Yes. It's designed to accommodate an unlimited number of listeners. However, the maximum number of people that can speak at once in one group is limited to four. Belt packs that are set to the same USER ID (DIP 1 and 2) and GROUP will interfere if they transmit at the same time. However, if two users are not expected to speak at the same time, they can share a USER ID.

## BP-900 BELT PACK

The ergonomically designed BP-900 AnchorMAN belt pack features an XLR headset jack, heavy duty antenna, headset volume control, microphone sensitivity control, group selection, PTT (push to talk) and transmission indicator LED. The belt pack is powered by 4 (included) "AA" NiMH rechargeable batteries.

### GROUP SELECTOR

To create a belt pack group, each member must set their Group Selector to the same letter - A, B, C or D. Press the GRP Button to change groups. The LED will light indicating the selected Group (A, B, C, D).

#### Example: Film Crew

The director assigns photography to Group A, sound to Group B and lighting to Group C. He can then be a part of any group by simply pressing the Group Selector Button to the desired group.

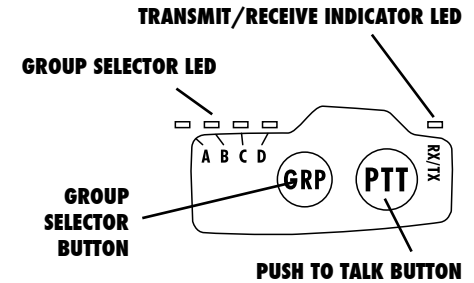

Due to the unique environmental conditions found at some locations (Example: Next to a radio station transmission tower.) you may find that one of the four Group settings experiences disruptive interference. Simply discontinue use of the effected Group and try the three remaining Groups to identify the clearest signal. For best results try the Group farthest from the affected Group first (If Group A has interference try Group D).

Due to the use of other wireless devices in your area, it may be possible for one or more channels within a frequency group to experience RF (radio frequency) interference. It may be necessary to audition all frequency groups prior to selecting the one that performs best for your application.

### PUSH TO TALK MODE / ACTIVE MODE

Push to Talk Mode (PTT) - Default mode when the PWR button is pushed. Press PTT button to speak to Group, release PTT button to listen.

Active Mode - Hands free voice activated operation (VOX) requires adjusting the Microphone Sensitivity level. Upon power up, belt packs default to low requiring PTT operation. Push the "+" button repeatedly to increase mic sensitivity until transmission is activated by the sound of your voice.

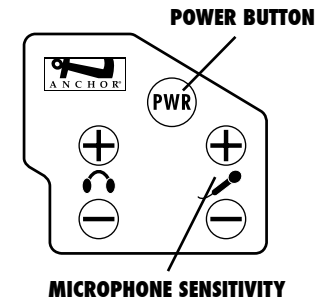

For videos on how to setup & use the AnchorMAN:  
[www.anchoraudio.com](http://www.anchoraudio.com)

## BASIC OPERATION

1. Charge batteries for 6 hours or until charger LED turns off

**NOTE: Belt packs operate about 7 hours per charge.**

2. Plug headset cable into belt pack & adjust boom
3. Hold down PWR button to turn belt pack ON
4. Set belt packs to same GROUP
5. Adjust Headset Volume level
6. Press & hold PTT button to talk, (*belt pack top*)  
release PTT button to listen

**NOTE: Repeat steps for each belt pack in the network.**

See page 3/Active Mode for voice activated operation.

## SYSTEM RANGE

AnchorMAN belt packs can communicate through many solid objects. However, if the solid objects contain metal or liquids, range will be reduced. Also, range will reduce as the path between belt packs becomes more obstructed. As belt packs get farther apart AnchorMAN automatically reverts to simplex mode for a maximum range of 2,500'/750m. This means you will operate in Push to Talk mode and speak one person at a time. If the signal fades the belt packs are too far apart and you will need to move closer together.

## DIP SWITCH FEATURES

The DIP Switches are located on the belt pack behind the antenna, to access flip antenna up. A description of DIP 1 & 2 can be found under Changing User ID Settings at the top of this page. DIP 3 is not in use at this time and should not be changed from the factory setting.

**CAUTION: Turn Belt Pack power OFF before making any changes to DIP switch settings.**

### DIP SWITCH 4 – ENABLE FIVE-MINUTE “TIMED” VOX MODE

When DIP 4 is set to the ON position, VOX transmissions will be limited to approximately 5 minutes. Each subsequent voice trigger will reset the five-minute timer.

### DIP SWITCH 5 – ENABLE ADJUSTABLE SQUELCH LEVEL (RSSI)

Set DIP 5 to the ON position to use the Headset Volume Control buttons to adjust the squelch level. Use this feature to minimize RF interference from the surrounding area.

**NOTE: A high squelch setting reduces interference but may reduce performance range.**

SWITCH	USER 1	USER 2	USER 3	USER 4
1	UP	DOWN	UP	DOWN
2	UP	UP	DOWN	DOWN

For videos on how to setup & use the AnchorMAN: [www.anchoraudio.com](http://www.anchoraudio.com)

GROUP SELECTOR LED

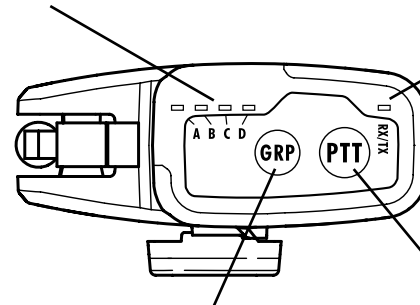

TRANSMIT/RECEIVE INDICATOR LED

GROUP SELECTOR BUTTON

Page 3

PUSH TO TALK BUTTON

Page 3

## ANCHORMAN BELT PACK

Model Shown: BP-900

ANTENNA JACK

SMA Connector

BELT CLIP

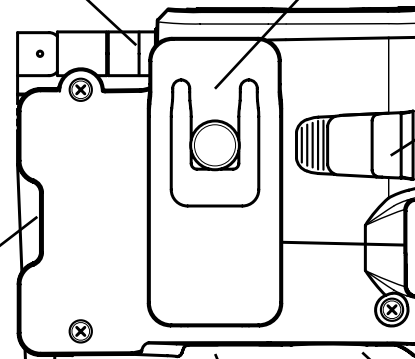

BATTERY COMPARTMENT

Press lightly & slide to remove cover

DIP SWITCHES

Preset at factory

DIP Settings:

HEADSET JACK

XLR Connector

CHARGER PORT & CHARGER LED

Connect Gang Charger for NiMH batteries

HEAVY DUTY ANTENNA

POWER BUTTON

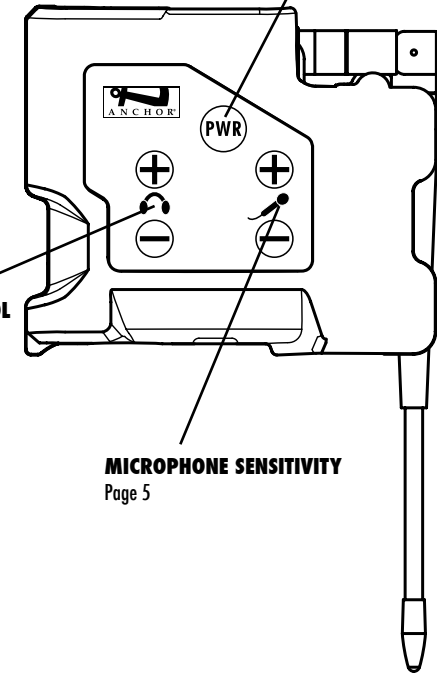

HEADSET VOLUME CONTROL

Page 5

MICROPHONE SENSITIVITY

Page 5

## WHAT IS ANCHORMAN®?

AnchorMAN is a wireless full duplex intercom system that is easy to configure and simple to operate. Up to four belt packs can talk at once and an unlimited number of belt packs can listen. Belt packs can be assigned to up to four separate groups. The transmitter and receiver operate utilizing FDMA techniques in the 945 - 951 MHz range without the need for a base station.